



Micro Angled Shroud Underwater Light

Micro Full Assemblies

M4B6-5.5W-27K-R

M4B6-5.5W-30K-R

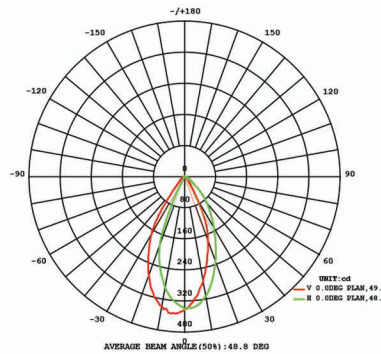
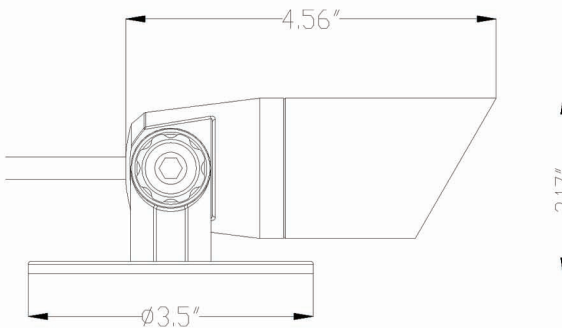

SPECIFICATIONS

- Construction: Brass
- Finish: Raw
- Lead Wire: 30ft long
- Mounting: Underwater Mount
- Light Source: Modular LED
- Wattage: 5.5W
- Operating Voltage: 12-15V
- Lumens: 254 LM
- Beam Spread: 50°
- Color Temperature: 2700K, 3000K



Fixture Type	Fixture Components	Fixture Material	Fixture Style	Watts	Color Temperature	Finish
M (Micro)	4 (Integrated Modular)	B (Brass)	6 (UWA)	5.5W (5.5W)	27K (2700K) 30K (3000K)	R (RAW)



ACCESSORIES



M4B1-3.5W-27K-R



M4B1-3.5W-30K-R



LAB-031-R



TR-120

WARRANTY

Lifetime Warranty on the Housing,
10 Year Warranty on the LED Light Source

CERTIFICATION

UL Listed I File #E501872

Lumien Lighting reserves the right to modify the design of our products at any time and data listed on spec sheets is subject to change.